

Die vielseitigen Kompakt-Vario-Zylinder mit ihren einzigartigen Anschlussvarianten sowie integrierten Sensornuten und einer der kürzesten Gesamtlängen, die auf dem Markt erhältlich ist, eignen sich für ein sehr breites Einsatzfeld.



- Auswahl zwischen verschiedenen Anschlussvarianten
- VDMA-Anschlussbild für Befestigungen bei Ø32 bis 100mm
- Korrosionsbeständige Leichtbau-Konstruktion
- Magnetkolben serienmäßig
- Elastische Dämpfungen für lange Lebensdauer
- Nahrungsmittelverträgliches Schmiermittel

Technische Daten

Betriebsdruck: max. 10 bar
 Arbeitsmedium: Druckluft geölt oder ungeölt
 Betriebstemperatur
 Standardausführung: -20 °C bis +80 °C
 Hochtemperatur-Ausf.: -10 °C bis +150 °C

Vorgefettet, weitere Schmierung ist normalerweise nicht erforderlich. Sollte man mit einer zusätzlichen Schmierung beginnen, muss damit fortgesetzt werden.

Nähere Informationen siehe CD

Doppeltwirkend – Kolbenstange mit Innengewinde

Ø20mm - (M5)

| Hub mm | Bestell-Nr. |
|--------|-----------------|
| 5 | P1M020VDMA7G005 |
| 10 | P1M020VDMA7G010 |
| 25 | P1M020VDMA7G025 |
| 40 | P1M020VDMA7G040 |
| 50 | P1M020VDMA7G050 |
| 80 | P1M020VDMA7G080 |
| 100 | P1M020VDMA7G100 |
| 125 | P1M020VDMA7G125 |
| 160 | P1M020VDMA7G160 |
| 200 | P1M020VDMA7G200 |

Ø25mm - (M5)

| Hub mm | Bestell-Nr. |
|--------|-----------------|
| 5 | P1M025VDMA7G005 |
| 10 | P1M025VDMA7G010 |
| 25 | P1M025VDMA7G025 |
| 40 | P1M025VDMA7G040 |
| 50 | P1M025VDMA7G050 |
| 80 | P1M025VDMA7G080 |
| 100 | P1M025VDMA7G100 |
| 125 | P1M025VDMA7G125 |
| 160 | P1M025VDMA7G160 |
| 200 | P1M025VDMA7G200 |

Ø32mm - (G1/8)

| Hub mm | Bestell-Nr. |
|--------|-----------------|
| 5 | P1M032VDMA7G005 |
| 10 | P1M032VDMA7G010 |
| 25 | P1M032VDMA7G025 |
| 40 | P1M032VDMA7G040 |
| 50 | P1M032VDMA7G050 |
| 80 | P1M032VDMA7G080 |
| 100 | P1M032VDMA7G100 |
| 125 | P1M032VDMA7G125 |
| 160 | P1M032VDMA7G160 |
| 200 | P1M032VDMA7G200 |
| 250 | P1M032VDMA7G250 |
| 320 | P1M032VDMA7G320 |

Ø40mm - (G1/8)

| Hub mm | Bestell-Nr. |
|--------|-----------------|
| 5 | P1M040VDMA7G005 |
| 10 | P1M040VDMA7G010 |
| 25 | P1M040VDMA7G025 |
| 40 | P1M040VDMA7G040 |
| 50 | P1M040VDMA7G050 |
| 80 | P1M040VDMA7G080 |
| 100 | P1M040VDMA7G100 |
| 125 | P1M040VDMA7G125 |
| 160 | P1M040VDMA7G160 |
| 200 | P1M040VDMA7G200 |
| 250 | P1M040VDMA7G250 |
| 320 | P1M040VDMA7G320 |

Ø50mm - (G1/8)

| Hub mm | Bestell-Nr. |
|--------|-----------------|
| 5 | P1M050VDMA7G005 |
| 10 | P1M050VDMA7G010 |
| 25 | P1M050VDMA7G025 |
| 40 | P1M050VDMA7G040 |
| 50 | P1M050VDMA7G050 |
| 80 | P1M050VDMA7G080 |
| 100 | P1M050VDMA7G100 |
| 125 | P1M050VDMA7G125 |
| 160 | P1M050VDMA7G160 |
| 200 | P1M050VDMA7G200 |
| 250 | P1M050VDMA7G250 |
| 320 | P1M050VDMA7G320 |

Ø63mm - (G1/8)

| Hub mm | Bestell-Nr. |
|--------|-----------------|
| 5 | P1M063VDMA7G005 |
| 10 | P1M063VDMA7G010 |
| 25 | P1M063VDMA7G025 |
| 40 | P1M063VDMA7G040 |
| 50 | P1M063VDMA7G050 |
| 80 | P1M063VDMA7G080 |
| 100 | P1M063VDMA7G100 |
| 125 | P1M063VDMA7G125 |
| 160 | P1M063VDMA7G160 |
| 200 | P1M063VDMA7G200 |
| 250 | P1M063VDMA7G250 |
| 320 | P1M063VDMA7G320 |
| 400 | P1M063VDMA7G400 |
| 500 | P1M063VDMA7G500 |

Ø80mm - (G1/4)

| Hub mm | Bestell-Nr. |
|--------|-----------------|
| 5 | P1M080VDMA7G005 |
| 10 | P1M080VDMA7G010 |
| 25 | P1M080VDMA7G025 |
| 40 | P1M080VDMA7G040 |
| 50 | P1M080VDMA7G050 |
| 80 | P1M080VDMA7G080 |
| 100 | P1M080VDMA7G100 |
| 125 | P1M080VDMA7G125 |
| 160 | P1M080VDMA7G160 |
| 200 | P1M080VDMA7G200 |
| 250 | P1M080VDMA7G250 |
| 320 | P1M080VDMA7G320 |
| 400 | P1M080VDMA7G400 |
| 500 | P1M080VDMA7G500 |

Ø100mm - (G1/4)

| Hub mm | Bestell-Nr. |
|--------|-----------------|
| 5 | P1M100VDMA7G005 |
| 10 | P1M100VDMA7G010 |
| 25 | P1M100VDMA7G025 |
| 40 | P1M100VDMA7G040 |
| 50 | P1M100VDMA7G050 |
| 80 | P1M100VDMA7G080 |
| 100 | P1M100VDMA7G100 |
| 125 | P1M100VDMA7G125 |
| 160 | P1M100VDMA7G160 |
| 200 | P1M100VDMA7G200 |
| 250 | P1M100VDMA7G250 |
| 320 | P1M100VDMA7G320 |
| 400 | P1M100VDMA7G400 |
| 500 | P1M100VDMA7G500 |

 Lagerware.

Sensoren



Hinweis: Sensoren siehe Seiten 96.

Abmessungen (mm)

Doppeltwirkend
Standardzylinder

Anschlussposition G, J

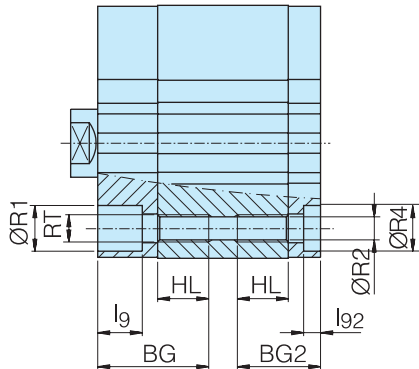

Anschlussposition H

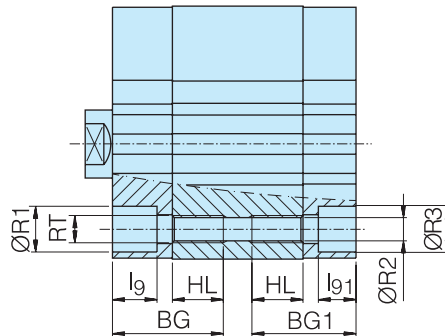

Anschlussposition G

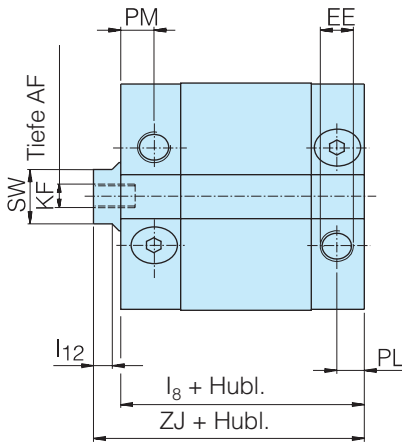

Anschlussposition H

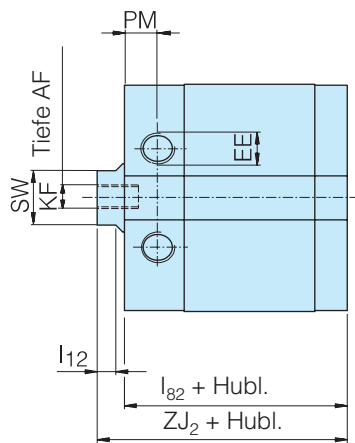

Anschlussposition J

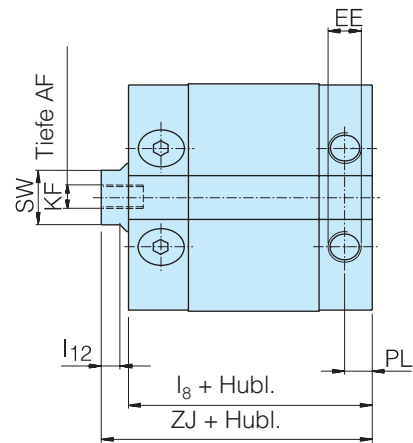

| Zylinder Bezeichn. | AF mm | BG mm | BG1 mm | BG2 mm | EE | HL mm | l8 mm | l9* mm | l12 mm | l82 mm | l91* mm | l92* mm | KF |
|--------------------|-------|-------|--------|--------|------|-------|-------|--------|--------|--------|---------|---------|-----|
| P1M012 | 6 | 25,5 | 20,5 | 15,5 | M5 | 12 | 40,0 | 3,5 | 3,0 | 35,0 | 3,5 | 3,5 | M3 |
| P1M016 | 8 | 26,0 | 21,0 | 15,5 | M5 | 12 | 41,5 | 5,5 | 3,0 | 36,5 | 3,0 | 4,0 | M4 |
| P1M020 | 10 | 32,5 | 27,0 | 22,0 | M5 | 18 | 42,5 | 10,5 | 4,0 | 37,5 | 5,0 | 4,5 | M5 |
| P1M025 | 12 | 32,5 | 29,0 | 23,0 | M5 | 18 | 44,5 | 4,1 | 4,0 | 38,5 | 4,1 | 5,0 | M6 |
| P1M032 | 12 | 41,5 | 39,0 | 31,0 | G1/8 | 24 | 49,0 | 4,5 | 5,0 | 41,0 | 4,5 | 4,0 | M6 |
| P1M040 | 12 | 41,5 | 39,5 | 31,0 | G1/8 | 24 | 50,5 | 7,2 | 5,5 | 42,5 | 5,2 | 3,5 | M6 |
| P1M050 | 12 | 42,5 | 40,5 | 34,5 | G1/8 | 25 | 51,0 | 5,2 | 5,5 | 44,5 | 5,2 | 5,0 | M8 |
| P1M063 | 12 | 43,5 | 40,5 | 35,0 | G1/8 | 25 | 55,5 | 6,5 | 5,5 | 50,0 | 6,5 | 4,0 | M8 |
| P1M080 | 14 | 51,0 | 51,0 | 42,0 | G1/4 | 30 | 63,5 | 9,5 | 6,0 | 54,5 | 9,5 | 8,5 | M10 |
| P1M100 | 16 | 52,0 | 52,0 | 43,5 | G1/4 | 30 | 72,5 | 9,5 | 6,0 | 64,0 | 9,5 | 8,5 | M12 |

| Zylinder-Bezeichn. | PL mm | PM mm | R1* mm | R2 mm | R3* mm | R4* mm | RT mm | SW mm | ZJ mm | ZJ2 mm |
|--------------------|-------|-------|--------|-------|--------|--------|-------|-------|-------|--------|
| P1M012 | 5,0 | 8,0 | 6,0 | 3,5 | 6,0 | 6,0 | M4 | 5 | 43,5 | 38,5 |
| P1M016 | 5,0 | 9,0 | 7,5 | 3,5 | 6,0 | 6,0 | M4 | 7 | 45,0 | 40,0 |
| P1M020 | 5,0 | 9,0 | 10,5 | 5,0 | 9,0 | 9,0 | M6 | 9 | 47,0 | 42,0 |
| P1M025 | 7,0 | 9,0 | 10,5 | 5,0 | 9,0 | 9,0 | M6 | 9 | 49,5 | 43,5 |
| P1M032 | 8,0 | 10,5 | 10,5 | 5,0 | 9,5 | 9,5 | M6 | 10 | 57,0 | 48,5 |
| P1M040 | 7,5 | 9,5 | 10,5 | 5,0 | 10,5 | 10,5 | M6 | 13 | 58,5 | 50,5 |
| P1M050 | 8,0 | 10,0 | 14,5 | 7,0 | 14,5 | 11,0 | M8 | 16 | 59,0 | 52,5 |
| P1M063 | 8,0 | 11,0 | 10,5 | 7,0 | 10,5 | 10,5 | M8 | 16 | 63,5 | 58,0 |
| P1M080 | 11,5 | 11,5 | 14,0 | 8,5 | 14,0 | 14,0 | M10 | 21 | 73,5 | 64,5 |
| P1M100 | 12,0 | 12,0 | 14,0 | 8,5 | 14,0 | 14,0 | M10 | 21 | 84,5 | 76,0 |

Längentoleranz ±1 mm Hublängentoleranz +1,5/0 mm

Abmessungen (mm)

Einfachwirkend und Hochtemperaturausführung

Anschlussposition G, J

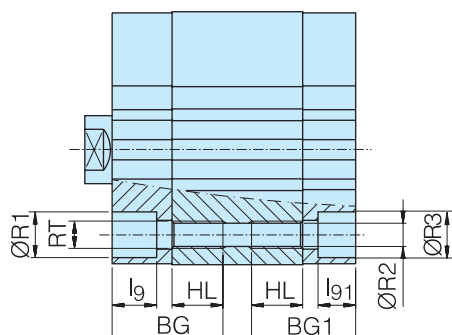

Anschlussposition H

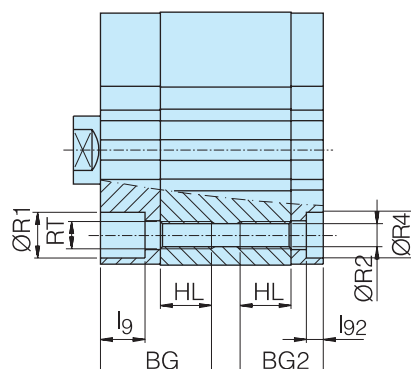

Anschlussposition G

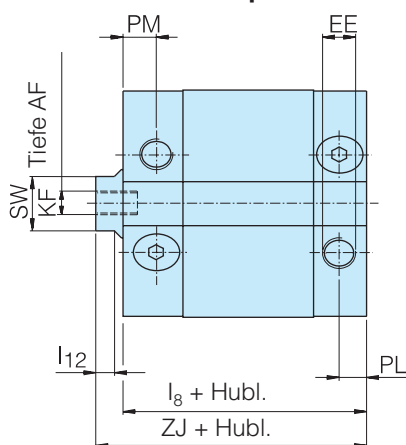

Anschlussposition H

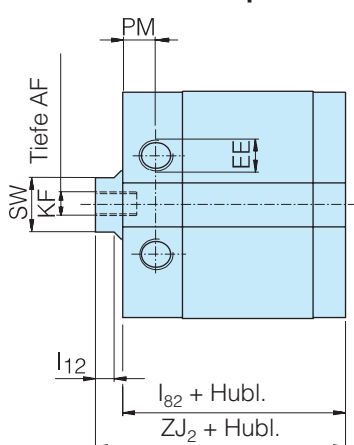

Anschlussposition J

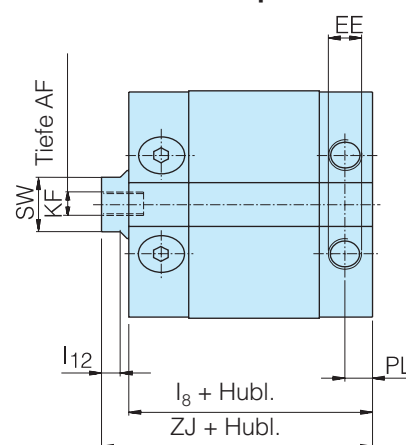

| Zylinder Bezeichn. | AF mm | BG mm | BG1 mm | BG2 mm | EE | HL mm | l8 mm | l9* mm | l12 mm | l82 mm | l91* mm | l92* mm | KF |
|--------------------|-------|-------|--------|--------|------|-------|-------|--------|--------|--------|---------|---------|-----|
| P1M012 | 6 | 25,5 | 20,5 | 15,5 | M5 | 12 | 40,0 | 3,5 | 3,0 | 35,0 | 3,5 | 3,5 | M3 |
| P1M016 | 8 | 26,0 | 21,0 | 15,5 | M5 | 12 | 41,5 | 5,5 | 3,0 | 36,5 | 3,0 | 4,0 | M4 |
| P1M020 | 10 | 32,5 | 27,0 | 22,0 | M5 | 18 | 42,5 | 10,5 | 4,0 | 37,5 | 5,0 | 4,5 | M5 |
| P1M025 | 12 | 32,5 | 29,0 | 23,0 | M5 | 18 | 44,5 | 10,5 | 4,0 | 38,5 | 7,0 | 5,0 | M6 |
| P1M032 | 12 | 41,5 | 39,0 | 31,0 | G1/8 | 24 | 49,0 | 14,5 | 5,0 | 41,0 | 12,5 | 4,0 | M6 |
| P1M040 | 12 | 41,5 | 39,5 | 31,0 | G1/8 | 24 | 50,5 | 14,0 | 5,5 | 42,5 | 12,0 | 4,0 | M6 |
| P1M050 | 12 | 42,5 | 40,5 | 34,5 | G1/8 | 25 | 51,0 | 13,0 | 5,5 | 44,5 | 11,0 | 5,0 | M8 |
| P1M063 | 12 | 43,5 | 40,5 | 35,0 | G1/8 | 25 | 55,5 | 6,5 | 5,5 | 50,0 | 6,5 | 6,5 | M8 |
| P1M080 | 14 | 51,0 | 51,0 | 42,0 | G1/4 | 30 | 63,5 | 9,5 | 6,0 | 54,5 | 9,5 | 8,5 | M10 |
| P1M100 | 16 | 52,0 | 52,0 | 43,5 | G1/4 | 30 | 72,5 | 9,5 | 6,0 | 64,0 | 9,5 | 8,5 | M12 |

| Zylinder Bezeichn. | PL mm | PM mm | R1* mm | R2 mm | R3* mm | R4* mm | RT mm | SW | ZJ mm | ZJ2 mm |
|--------------------|-------|-------|--------|-------|--------|--------|-------|----|-------|--------|
| P1M012 | 5,0 | 8,0 | 6,0 | 3,5 | 6,0 | 6,0 | M4 | 5 | 43,5 | 38,5 |
| P1M016 | 5,0 | 9,0 | 7,5 | 3,5 | 6,0 | 6,0 | M4 | 7 | 45,0 | 40,0 |
| P1M020 | 5,0 | 9,0 | 10,5 | 5,0 | 9,0 | 9,0 | M6 | 9 | 47,0 | 42,0 |
| P1M025 | 7,0 | 9,0 | 10,5 | 5,0 | 9,0 | 9,0 | M6 | 9 | 49,5 | 43,5 |
| P1M032 | 8,0 | 10,5 | 10,5 | 5,0 | 10,5 | 10,5 | M6 | 10 | 57,0 | 48,5 |
| P1M040 | 7,5 | 9,5 | 10,5 | 5,0 | 10,5 | 10,5 | M6 | 13 | 58,5 | 50,5 |
| P1M050 | 8,0 | 10,0 | 13,5 | 7,0 | 13,5 | 13,5 | M8 | 16 | 59,0 | 52,5 |
| P1M063 | 8,0 | 11,0 | 10,5 | 7,0 | 10,5 | 10,5 | M8 | 16 | 63,5 | 58,0 |
| P1M080 | 11,5 | 11,5 | 14,0 | 8,5 | 14,0 | 14,0 | M10 | 21 | 73,5 | 64,5 |
| P1M100 | 12,0 | 12,0 | 14,0 | 8,5 | 14,0 | 14,0 | M10 | 21 | 84,5 | 76,0 |

Längentoleranz ±1 mm Hublängentoleranz +1,5/0 mm



Abmessungen (mm)

Anschlussposition G, H, J

Abmessungen Ø12 bis Ø50 mm

2 Befestigungsbohrungen

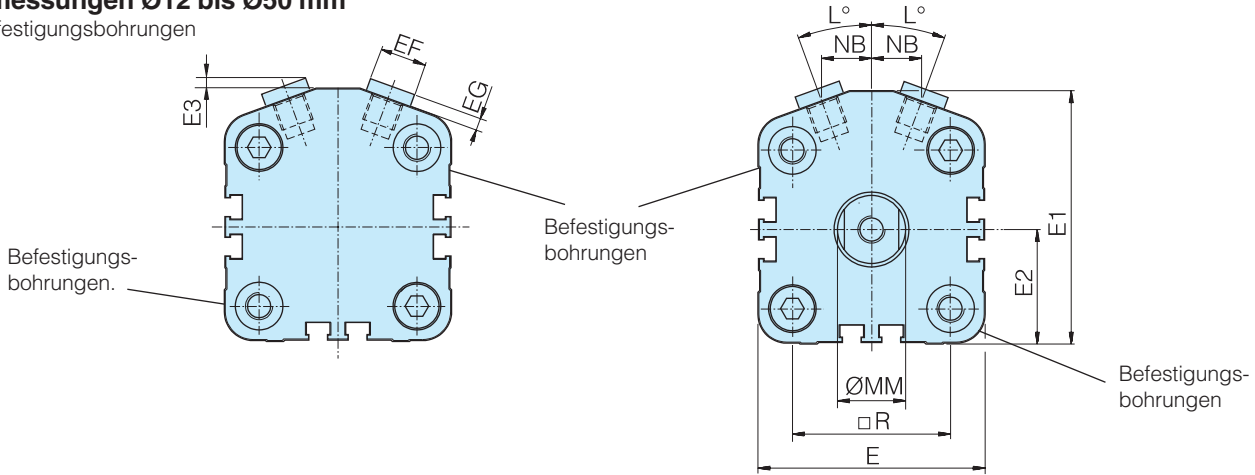

Abmessungen Ø63 bis Ø100 mm

4 Befestigungsbohrungen

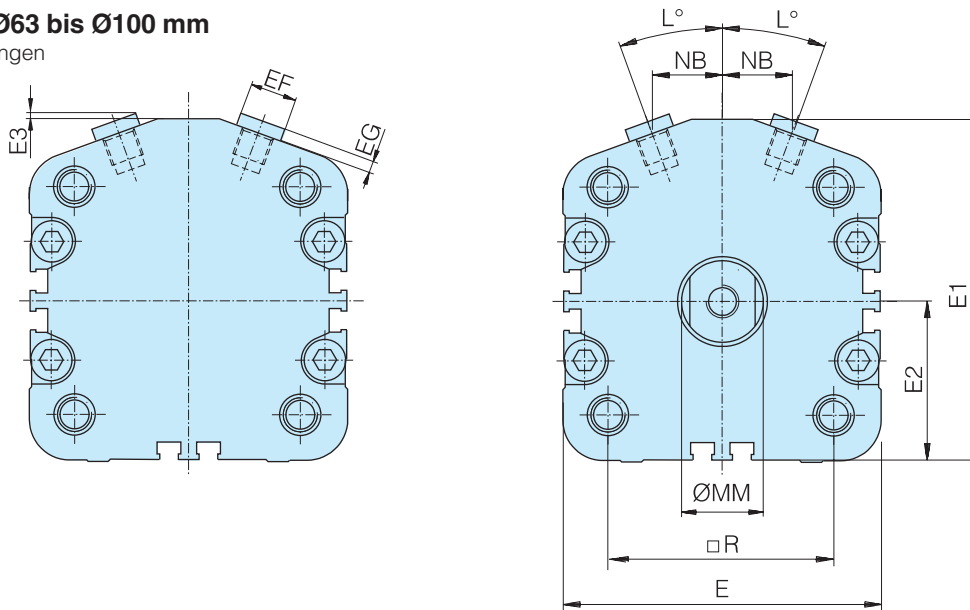

| Zylinder Bezeichn. | E mm | E1 mm | E2 mm | E3 mm | EE mm | EF mm | EG mm | L ° | MM mm | NB mm | R mm |
|--------------------|-------|-------|-------|-------|-------|-------|-------|-----|-------|-------|------|
| P1M 012 | 27,0 | 31,0 | 14,0 | - | M5 | - | - | 26° | 6 | 5,5 | 15,5 |
| P1M 016 | 31,5 | 35,0 | 16,0 | - | M5 | - | - | 20° | 8 | 6,5 | 20,0 |
| P1M 020 | 38,5 | 42,5 | 19,5 | 3,5 | M5 | 7* | 4,5 | 20° | 10 | 7,5 | 25,5 |
| P1M 025 | 41,5 | 45,5 | 21,0 | 3,5 | M5 | 7* | 4,5 | 20° | 10 | 8,5 | 28,0 |
| P1M 032 | 48,0 | 56,0 | 24,0 | 3,0 | G1/8 | 14 | 2,5 | 20° | 12 | 9,5 | 32,5 |
| P1M 040 | 56,0 | 62,5 | 28,0 | 3,0 | G1/8 | 14 | 2,5 | 20° | 16 | 11,5 | 38,0 |
| P1M 050 | 67,0 | 74,5 | 33,5 | 3,0 | G1/8 | 14 | 2,5 | 20° | 20 | 14,5 | 46,5 |
| P1M 063 | 82,0 | 86,0 | 40,5 | 2,5 | G1/8 | 14 | 2,5 | 20° | 20 | 17,5 | 56,5 |
| P1M 080 | 98,0 | 106,5 | 48,5 | 2,5 | G1/4 | 17 | 3,0 | 20° | 25 | 25,5 | 72,0 |
| P1M 100 | 119,0 | 126,5 | 59,5 | 2,5 | G1/4 | 17 | 3,0 | 20° | 25 | 31,5 | 89,0 |

** Sechskantkopf

Abmessungen (mm)

Kolbenstangengewinde 8 (aussen)

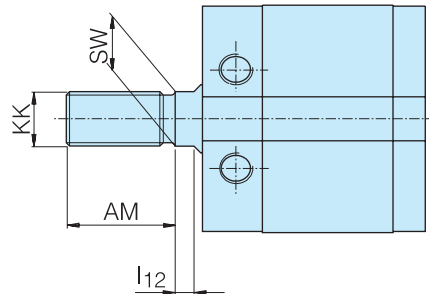

Zylindertyp K (durchgehende Kolbenstange)

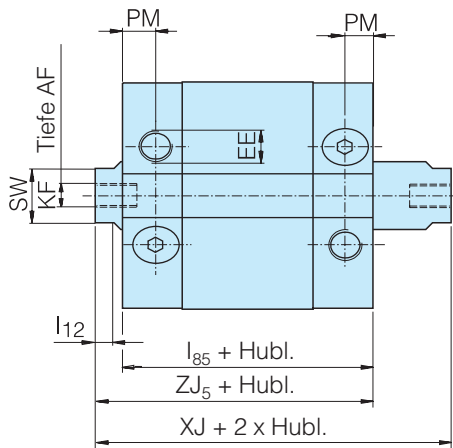

Zylindertyp H (durchgehende hohlgebohrte Kolbenstange)

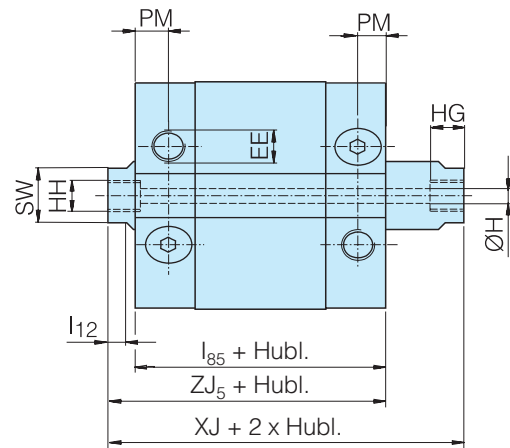

| Zylinder Bezeichn. | AF mm | AM mm | H* mm | HG mm | HH mm | l12 mm | l85 mm | KF mm | KK mm | PM mm | SW mm | XJ mm | ZJ5 mm |
|--------------------|-------|-------|-------|-------|-------|--------|--------|-------|----------|-------|-------|-------|--------|
| P1M 012 | 6 | 16 | - | - | - | 3,0 | 46,0 | M3 | M6 | 8,0 | 5 | 54,0 | 50,0 |
| P1M 016 | 8 | 20 | - | - | - | 3,0 | 47,5 | M4 | M6 | 9,0 | 7 | 54,5 | 51,5 |
| P1M 020 | 10 | 22 | 3 | 7 | M5 | 4,0 | 49,5 | M5 | M8 | 9,0 | 9 | 58,5 | 54,0 |
| P1M 025 | 12 | 22 | 3 | 7 | M5 | 4,0 | 49,5 | M6 | M10X1,25 | 9,0 | 9 | 60,0 | 55,0 |
| P1M 032 | 12 | 22 | 3 | 7 | G1/8 | 5,0 | 51,5 | M6 | M10X1,25 | 10,5 | 10 | 67,5 | 59,5 |
| P1M 040 | 12 | 24 | 4 | 8 | G1/8 | 5,5 | 52,5 | M6 | M12X1,25 | 9,5 | 13 | 69,0 | 60,5 |
| P1M 050 | 12 | 32 | 5 | 8 | G1/8 | 5,5 | 53,0 | M8 | M16X1,5 | 10,0 | 16 | 69,0 | 61,0 |
| P1M 063 | 12 | 32 | 5 | 8 | G1/8 | 5,5 | 58,5 | M8 | M16X1,5 | 11,0 | 16 | 75,0 | 66,5 |
| P1M 080 | 14 | 40 | 6 | 11 | G1/4 | 6,0 | 63,5 | M10 | M20X1,5 | 11,5 | 21 | 84,0 | 73,5 |
| P1M 100 | 16 | 40 | 6 | 11 | G1/4 | 6,0 | 72,5 | M12 | M20X1,5 | 12,0 | 21 | 97,0 | 84,5 |

* Mass H nur für Zylindertyp H
Längentoleranz ±1 mm
Hublängentoleranz +1,5/0 mm

Abmessungen (mm)

Flanschbefestigung MF1/MF2

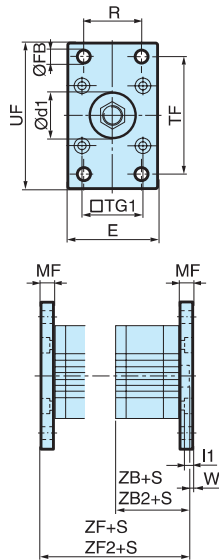

| Zyl. Ø | d1 | FB | TG1 | E | R | MF | TF | UF | I1 | W | ZF* | ZB* | ZF2* | ZB2* | Bestell-Nr. |
|--------|------|------|------|-----|----|------|-------|-----|-----|-----|------|------|-------|------|-----------------|
| mm | mm | mm | mm | mm | mm | mm | mm | mm | mm | mm | mm | mm | mm | mm | |
| 12 | 9,0 | 4,5 | 15,5 | 25 | - | 5,5 | 45,0 | 55 | 3,0 | 2,0 | 44,0 | 38,5 | 49,0 | 43,5 | P1M-4DMB |
| 16 | 11,5 | 4,5 | 20,0 | 30 | - | 5,5 | 45,0 | 55 | 3,0 | 2,0 | 45,5 | 40,0 | 50,5 | 45,0 | P1M-4FMB |
| 20 | 14,0 | 6,6 | 25,5 | 39 | - | 8,0 | 50,5 | 62 | 4,2 | 4,5 | 49,0 | 41,0 | 54,0 | 46,0 | P1M-4HMB |
| 25 | 14,0 | 6,6 | 28,0 | 42 | - | 8,0 | 53,0 | 65 | 4,2 | 3,0 | 51,5 | 43,5 | 56,5 | 49,5 | P1M-4JMB |
| 32 | 30,0 | 7,0 | 32,5 | 45 | 32 | 10,0 | 64,0 | 80 | 5,0 | 2,0 | 58,5 | 48,5 | 67,0 | 57,0 | P1C-4KMB |
| 40 | 35,0 | 9,0 | 38,0 | 52 | 36 | 10,0 | 72,0 | 90 | 5,0 | 2,0 | 60,5 | 50,5 | 68,5 | 58,5 | P1C-4LMB |
| 50 | 40,0 | 9,0 | 46,5 | 65 | 45 | 12,0 | 90,0 | 110 | 6,5 | 4,0 | 64,5 | 52,5 | 71,0 | 59,0 | P1C-4MMB |
| 63 | 45,0 | 9,0 | 56,5 | 75 | 50 | 12,0 | 100,0 | 120 | 6,5 | 4,0 | 70,0 | 58,0 | 75,5 | 63,5 | P1C-4NMB |
| 80 | 45,0 | 12,0 | 72,0 | 95 | 63 | 16,0 | 126,0 | 150 | 8,0 | 6,0 | 80,5 | 64,5 | 89,5 | 73,5 | P1C-4PMB |
| 100 | 55,0 | 14,0 | 89,0 | 115 | 75 | 16,0 | 150,0 | 170 | 8,0 | 4,0 | 92,0 | 76,0 | 100,5 | 84,5 | P1C-4QMB |

S = Hublänge

* ZF, ZB für Zylinder mit beiden Anschlüssen im vorderen Deckel (Ausführung H)
ZF2, ZB2 für die anderen Zylinder (Ausführungen G, J, K)

Fussbefestigung MS1

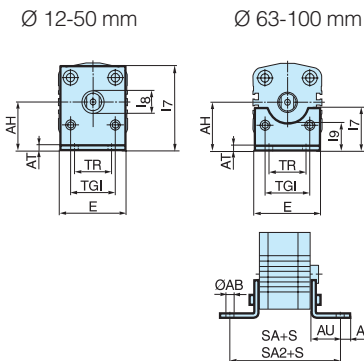

| Zyl. Ø | AB | TG1 | E | TR | AO | AU | AH | I7 | AT | I9 | I8 | SA* | SA2* | Bestell-Nr. |
|--------|------|------|-----|----|------|------|----|------|------|------|----|-------|-------|-----------------|
| mm | mm | mm | mm | mm | mm | mm | mm | mm | mm | mm | mm | mm | mm | |
| 12 | 4,5 | 15,5 | 44 | 35 | 5,5 | 8,0 | 17 | 29,5 | 2 | - | 8 | 51,0 | 56,0 | P1M-4DMF |
| 16 | 4,5 | 20,0 | 48 | 39 | 6,0 | 8,0 | 19 | 33,5 | 2 | - | 10 | 52,5 | 57,5 | P1M-4FMF |
| 20 | 6,6 | 25,5 | 62 | 50 | 7,5 | 9,0 | 24 | 42,0 | 3,2 | - | 12 | 59,5 | 64,5 | P1M-4HMF |
| 25 | 6,6 | 28,0 | 66 | 52 | 7,5 | 10,5 | 26 | 46,0 | 3,2 | - | 12 | 59,5 | 65,5 | P1M-4JMF |
| 32 | 7,0 | 32,5 | 45 | 32 | 11,0 | 24,0 | 32 | 54,5 | 8,0 | - | 30 | 88,5 | 97,0 | P1C-4KMZ |
| 40 | 9,0 | 38,0 | 52 | 36 | 7,0 | 28,0 | 36 | 62,0 | 8,0 | - | 35 | 98,5 | 106,5 | P1C-4LMZ |
| 50 | 9,0 | 46,5 | 65 | 45 | 13,0 | 32,0 | 45 | 77,5 | 10,0 | - | 40 | 108,5 | 115,0 | P1C-4MMZ |
| 63 | 9,0 | 56,5 | 75 | 50 | 13,0 | 32,0 | 50 | 35,0 | 5,5 | 27,5 | - | 114,0 | 119,5 | P1C-4NMF |
| 80 | 12,0 | 72,0 | 95 | 63 | 14,0 | 41,0 | 63 | 49,0 | 6,5 | 40,5 | - | 136,5 | 145,5 | P1C-4PMF |
| 100 | 14,0 | 89,0 | 115 | 75 | 15,0 | 41,0 | 71 | 54,0 | 6,5 | 43,5 | - | 146,0 | 154,5 | P1C-4QMF |

S = Hublänge

SA für Zylinder mit beiden Anschlüssen im vorderen Deckel (Ausführung H)
SA2 für die anderen Zylinder (Ausführungen G, J, K)

Lagerbock mit starrem Lager

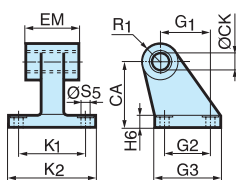

| Zyl. Ø | CK | S5 | K1 | K2 | G1 | G2 | EM | G3 | CA | H6 | R1 | Bestell-Nr. |
|--------|----|------|----|----|----|----|------|----|----|----|----|-----------------|
| mm | mm | mm | mm | mm | mm | mm | mm | mm | mm | mm | mm | |
| 32 | 10 | 6,6 | 38 | 51 | 21 | 18 | 25,5 | 31 | 32 | 8 | 10 | P1C-4KMD |
| 40 | 12 | 6,6 | 41 | 54 | 24 | 22 | 27,0 | 35 | 36 | 10 | 11 | P1C-4LMD |
| 50 | 12 | 9,0 | 50 | 65 | 33 | 30 | 31,0 | 45 | 45 | 12 | 13 | P1C-4MMD |
| 63 | 16 | 9,0 | 52 | 67 | 37 | 35 | 39,0 | 50 | 50 | 12 | 15 | P1C-4NMD |
| 80 | 16 | 11,0 | 66 | 86 | 47 | 40 | 49,0 | 60 | 63 | 14 | 15 | P1C-4PMD |
| 100 | 20 | 11,0 | 76 | 96 | 55 | 50 | 59,0 | 70 | 71 | 15 | 19 | P1C-4QMD |

Abmessungen (mm)

Gabelbefestigung MP2

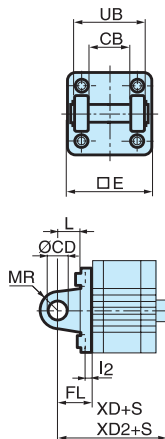

| Zyl. Ø mm | E h14 mm | UB H14 mm | CB ±0,2 mm | FL mm | L mm | I2 H9 mm | CD mm | MR mm | XD* mm | XD2* mm | Bestell-Nr. |
|-----------------|----------------|-----------------|------------------|----------|---------|----------------|----------|----------|-----------|------------|-----------------|
| 12 | 27,0 | 10 | 5,2 | 14 | 7 | - | 5 | 6 | 52,5 | 57,5 | P1M-4DMT |
| 16 | 31,5 | 12 | 6,7 | 15 | 10 | - | 5 | 6 | 55,0 | 60,0 | P1M-4FMT |
| 20 | 38,5 | 16 | 8,2 | 18 | 12 | - | 8 | 9 | 59,0 | 65,0 | P1M-4HMT |
| 25 | 41,0 | 20 | 10,2 | 20 | 14 | - | 10 | 10 | 63,5 | 69,5 | P1M-4JMT |
| 32 | 45,0 | 45 | 26,0 | 22 | 13 | 5,5 | 10 | 10 | 70,5 | 79,0 | P1C-4KMT |
| 40 | 52,0 | 52 | 28,0 | 25 | 16 | 5,5 | 12 | 12 | 75,5 | 83,5 | P1C-4LMT |
| 50 | 65,0 | 60 | 32,0 | 27 | 16 | 6,5 | 12 | 12 | 79,5 | 86,0 | P1C-4MMT |
| 63 | 75,0 | 70 | 40,0 | 32 | 21 | 6,5 | 16 | 16 | 90,0 | 95,5 | P1C-4NMT |
| 80 | 95,0 | 90 | 50,0 | 36 | 22 | 10,0 | 16 | 16 | 100,5 | 109,5 | P1C-4PMT |
| 100 | 115,0 | 110 | 60,0 | 41 | 27 | 10,0 | 20 | 20 | 117,0 | 125,5 | P1C-4QMT |

S = Hublänge

* XD für Zylinder mit beiden Anschlüssen im vorderen Deckel (Ausführung H)
XD2 für die anderen Zylinder (Ausführungen G, J, K)

Gegenlager MP4

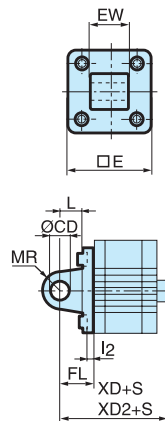

| Zyl. Ø mm | E mm | EW mm | FL ±0,2 mm | L mm | I2 mm | CD H9 mm | MR mm | XD* mm | XD2* mm | Bestell-Nr. |
|-----------------|---------|----------|------------------|---------|----------|----------------|----------|-----------|------------|-----------------|
| 12 | 27,0 | 4,7 | 14 | 7 | - | 5 | 6 | 52,5 | 57,5 | P1M-4DME |
| 16 | 31,5 | 6,2 | 15 | 10 | - | 5 | 6 | 55,0 | 60,0 | P1M-4FME |
| 20 | 38,5 | 7,7 | 18 | 12 | - | 8 | 9 | 59,0 | 65,0 | P1M-4HME |
| 25 | 41,0 | 9,7 | 20 | 14 | - | 10 | 10 | 63,5 | 69,5 | P1M-4JME |
| 32 | 45,0 | 26,0 | 22 | 13 | 5,5 | 10 | 10 | 70,5 | 79,0 | P1C-4KME |
| 40 | 52,0 | 28,0 | 25 | 16 | 5,5 | 12 | 12 | 75,5 | 83,5 | P1C-4LME |
| 50 | 65,0 | 32,0 | 27 | 16 | 6,5 | 12 | 12 | 79,5 | 86,0 | P1C-4MME |
| 63 | 75,0 | 40,0 | 32 | 21 | 6,5 | 16 | 16 | 90,0 | 95,5 | P1C-4NME |
| 80 | 95,0 | 50,0 | 36 | 22 | 10,0 | 16 | 16 | 100,5 | 109,5 | P1C-4PME |
| 100 | 115,0 | 60,0 | 41 | 27 | 10,0 | 20 | 20 | 117,0 | 125,5 | P1C-4QME |

S = Hublänge

* XD für Zylinder mit beiden Anschlüssen im vorderen Deckel (Ausführung H)
XD2 für die anderen Zylinder (Ausführungen G, J, K)

Gabelbefestigung GA

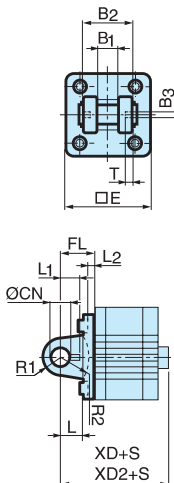

| Zyl. Ø mm | E mm | B2 d12 mm | B1 H14 mm | T mm | B3 mm | R2 mm | L1 mm | FL ±0,2 mm | I2 mm | L mm | CN F7 mm | R1 mm | XD* mm | XD2* mm | Bestell-Nr. |
|-----------------|---------|-----------------|-----------------|---------|----------|----------|----------|------------------|----------|---------|----------------|----------|-----------|------------|------------------|
| 32 | 45 | 34 | 14 | 3 | 3,3 | 17 | 11,5 | 22 | 5,5 | 12 | 10 | 11 | 70,5 | 79,0 | P1C-4KMCA |
| 40 | 52 | 40 | 16 | 4 | 4,3 | 20 | 12,0 | 25 | 5,5 | 15 | 12 | 13 | 75,5 | 83,5 | P1C-4LMCA |
| 50 | 65 | 45 | 21 | 4 | 4,3 | 22 | 14,0 | 27 | 6,5 | 17 | 16 | 18 | 79,5 | 86,0 | P1C-4MMCA |
| 63 | 75 | 51 | 21 | 4 | 4,3 | 25 | 14,0 | 32 | 6,5 | 20 | 16 | 18 | 90,0 | 95,5 | P1C-4NMCA |
| 80 | 95 | 65 | 25 | 4 | 4,3 | 30 | 16,0 | 36 | 10,0 | 20 | 20 | 22 | 100,5 | 109,5 | P1C-4PMCA |
| 100 | 115 | 75 | 25 | 4 | 4,3 | 32 | 16,0 | 41 | 10,0 | 25 | 20 | 22 | 117,0 | 125,5 | P1C-4QMCA |

S = Hublänge

* XD für Zylinder mit beiden Anschlüssen im vorderen Deckel (Ausführung H)
XD2 für die anderen Zylinder (Ausführungen G, J, K)

Abmessungen (mm)

Lagerbock mit Gelenklager

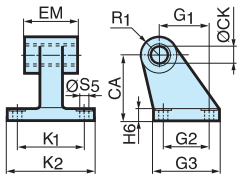

| Zyl. Ø | CN H7 | S5 H13 | K1 JS14 | K2 | EU | G1 JS14 | G2 JS14 | EN | G3 | CH JS15 | H6 | ER | Z | Bestell-Nr. |
|-----------|----------|-----------|------------|----|------|------------|------------|----|----|------------|----|----|----|-----------------|
| mm | mm | mm | mm | mm | mm | mm | mm | mm | mm | mm | mm | mm | mm | |
| 32 | 10 | 6,6 | 38 | 51 | 10,5 | 21 | 18 | 14 | 31 | 32 | 10 | 16 | 4° | P1C-4KMA |
| 40 | 12 | 6,6 | 41 | 54 | 12,0 | 24 | 22 | 16 | 35 | 36 | 10 | 18 | 4° | P1C-4LMA |
| 50 | 16 | 9,0 | 50 | 65 | 15,0 | 33 | 30 | 21 | 45 | 45 | 12 | 21 | 4° | P1C-4MMA |
| 63 | 16 | 9,0 | 52 | 67 | 15,0 | 37 | 35 | 21 | 50 | 50 | 12 | 23 | 4° | P1C-4NMA |
| 80 | 20 | 11,0 | 66 | 86 | 18,0 | 47 | 40 | 25 | 60 | 63 | 14 | 28 | 4° | P1C-4PMA |
| 100 | 20 | 11,0 | 76 | 96 | 18,0 | 55 | 50 | 25 | 70 | 71 | 15 | 30 | 4° | P1C-4QMA |

Gegenlager mit Gelenklager

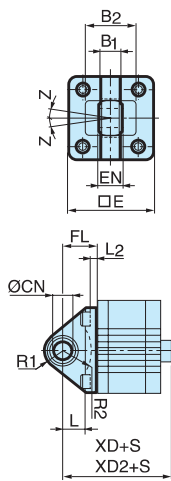

| Zyl. Ø | E | B1 | B2 | EN | R1 | R2 | FL | l2 | L | CN H7 | XD* | XD2* | Z | Bestell-Nr. |
|-----------|-----|------|----|----|----|----|----|------|----|----------|-------|-------|----|------------------|
| mm | mm | mm | mm | mm | mm | mm | mm | mm | mm | mm | mm | mm | mm | |
| 32 | 45 | 10,5 | 38 | 14 | 16 | 14 | 22 | 5,5 | 12 | 10 | 70,5 | 79,0 | 4° | P1C-4KMSA |
| 40 | 52 | 12,0 | 44 | 16 | 18 | 16 | 25 | 5,5 | 15 | 12 | 75,5 | 83,5 | 4° | P1C-4LMSA |
| 50 | 65 | 15,0 | 51 | 21 | 21 | 19 | 27 | 6,5 | 15 | 16 | 79,5 | 86,0 | 4° | P1C-4MMSA |
| 63 | 75 | 15,0 | 56 | 21 | 23 | 22 | 32 | 6,5 | 20 | 16 | 90,0 | 95,5 | 4° | P1C-4NMSA |
| 80 | 95 | 18,0 | 72 | 25 | 29 | 25 | 36 | 10,0 | 20 | 20 | 100,5 | 109,5 | 4° | P1C-4PMSA |
| 100 | 115 | 18,0 | 82 | 25 | 31 | 27 | 41 | 10,0 | 25 | 20 | 117,0 | 125,5 | 4° | P1C-4QMSA |

S = Hublänge

* XD für Zylinder mit beiden Anschlüssen im vorderen Deckel (Ausführung H)
XD2 für die anderen Zylinder (Ausführungen G, J, K)

Montagesatz

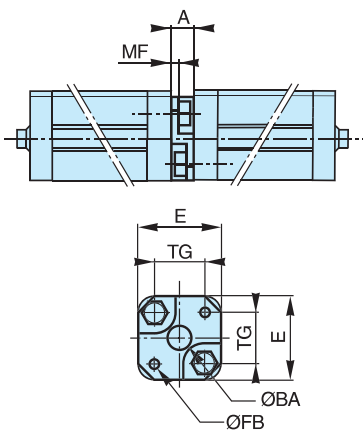

| Zyl. Ø | E | TG | ØFB | MF | A | ØBA | Bestell-Nr. |
|-----------|-----|------|------|----|----|-----|-----------------|
| mm | mm | mm | mm | mm | mm | mm | |
| 32 | 50 | 32,5 | 6,5 | 5 | 16 | 30 | P1E-6KB0 |
| 40 | 60 | 38,0 | 6,5 | 5 | 16 | 35 | P1E-6LB0 |
| 50 | 66 | 46,5 | 8,5 | 6 | 20 | 40 | P1E-6MB0 |
| 63 | 80 | 56,5 | 8,5 | 6 | 20 | 45 | P1E-6NB0 |
| 80 | 100 | 72,0 | 10,5 | 8 | 25 | 45 | P1E-6PB0 |
| 100 | 118 | 89,0 | 10,5 | 8 | 25 | 55 | P1E-6QB0 |

Montagesatz für 3- oder 4-Stellungszylinder

Abmessungen (mm)

Gelenkkopf

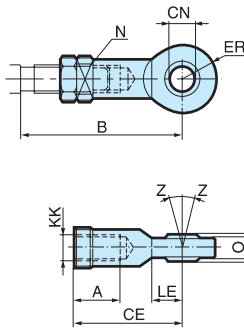

| Zyl. Ø mm | A | B min mm | B max mm | CE | CN H9 mm | EN h12 mm | ER | KK | LE min mm | M | N | O | Z | Bestell-Nr. |
|-----------------|----|----------------|----------------|----|----------------|-----------------|----|----------|-----------------|------|----|------|-----|-----------------|
| 12 | 9 | 37 | 40 | 30 | 6 | 9 | 10 | M6 | 10 | 3,2 | 10 | 6,8 | 10° | P1A-4DRS |
| 16 | 9 | 37 | 40 | 30 | 6 | 9 | 10 | M6 | 10 | 3,2 | 10 | 6,8 | 10° | P1A-4DRS |
| 20 | 12 | 44 | 48 | 36 | 8 | 12 | 12 | M8 | 12 | 4,0 | 13 | 9,0 | 12° | P1A-4HRS |
| 25 | 15 | 48 | 55 | 43 | 10 | 14 | 14 | M10X1,25 | 14 | 5,0 | 17 | 10,5 | 12° | P1A-4JRS |
| 32 | 20 | 48 | 55 | 43 | 10 | 14 | 14 | M10x1,25 | 15 | 5,0 | 17 | 10,5 | 12° | P1C-4KRS |
| 40 | 22 | 56 | 62 | 50 | 12 | 16 | 16 | M12x1,25 | 17 | 6,0 | 19 | 12,0 | 12° | P1C-4LRS |
| 50 | 28 | 72 | 80 | 64 | 16 | 21 | 21 | M16x1,5 | 22 | 8,0 | 22 | 15,0 | 15° | P1C-4MRS |
| 63 | 28 | 72 | 80 | 64 | 16 | 21 | 21 | M16x1,5 | 22 | 8,0 | 22 | 15,0 | 15° | P1C-4MRS |
| 80 | 33 | 87 | 97 | 77 | 20 | 25 | 25 | M20x1,5 | 26 | 10,0 | 32 | 18,0 | 15° | P1C-4PRS |
| 100 | 33 | 87 | 97 | 77 | 20 | 25 | 25 | M20x1,5 | 26 | 10,0 | 32 | 18,0 | 15° | P1C-4PRS |

Gabelkopf

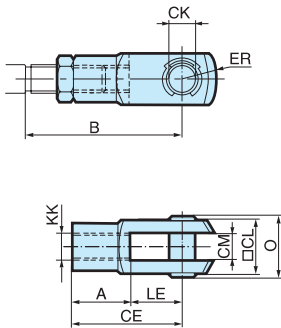

| Zyl. Ø mm | A | B min mm | B max mm | CE | CK h11/E9 mm | CL | CM | ER | KK | LE | M | O | Bestell-Nr. |
|-----------------|----|----------------|----------------|----|--------------------|----|----|----|----------|----|------|------|-----------------|
| 12 | 12 | 28 | 34 | 24 | 6 | 12 | 6 | 7 | M6 | 12 | 3,2 | 17,0 | P1A-4DRC |
| 16 | 12 | 28 | 34 | 24 | 6 | 12 | 6 | 7 | M6 | 12 | 3,2 | 17,0 | P1A-4DRC |
| 20 | 16 | 37 | 44 | 32 | 8 | 16 | 8 | 10 | M8 | 16 | 4,0 | 22,0 | P1A-4HRC |
| 25 | 20 | 45 | 52 | 40 | 10 | 20 | 10 | 12 | M10X1,25 | 20 | 5,0 | 28,0 | P1A-4JRC |
| 32 | 20 | 45 | 52 | 40 | 10 | 20 | 10 | 16 | M10x1,25 | 20 | 5,0 | 28,0 | P1C-4KRC |
| 40 | 24 | 54 | 60 | 48 | 12 | 24 | 12 | 19 | M12x1,25 | 24 | 6,0 | 32,0 | P1C-4LRC |
| 50 | 32 | 72 | 80 | 64 | 16 | 32 | 16 | 25 | M16x1,5 | 32 | 8,0 | 41,5 | P1C-4MRC |
| 63 | 32 | 72 | 80 | 64 | 16 | 32 | 16 | 25 | M16x1,5 | 32 | 8,0 | 41,5 | P1C-4MRC |
| 80 | 40 | 90 | 100 | 80 | 20 | 40 | 20 | 32 | M20x1,5 | 40 | 10,0 | 50,0 | P1C-4PRC |
| 100 | 40 | 90 | 100 | 80 | 20 | 40 | 20 | 32 | M20x1,5 | 40 | 10,0 | 50,0 | P1C-4PRC |

Flexo-Kupplung

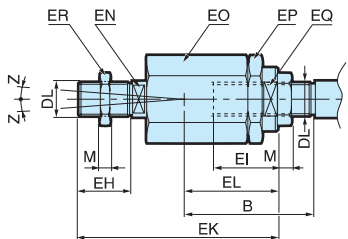

| Zyl. Ø mm | B min mm | B max mm | DL | EH | EI | EK | EL | EN | EO | EP | EQ | M | Z | Bestell-Nr. |
|-----------------|----------------|----------------|----------|----|----|-----|----|----|----|----|----|----|----|-----------------|
| 32 | 36 | 43 | M10x1,25 | 20 | 23 | 70 | 31 | 12 | 30 | 30 | 19 | 5 | 4° | P1C-4KRF |
| 40 | 37 | 43 | M12x1,25 | 23 | 23 | 67 | 31 | 12 | 30 | 30 | 19 | 6 | 4° | P1C-4LRF |
| 50 | 53 | 61 | M16x1,5 | 40 | 32 | 112 | 45 | 19 | 41 | 41 | 30 | 8 | 4° | P1C-4MRF |
| 63 | 53 | 61 | M16x1,5 | 40 | 32 | 112 | 45 | 19 | 41 | 41 | 30 | 8 | 4° | P1C-4MRF |
| 80 | 57 | 67 | M20x1,5 | 39 | 42 | 122 | 56 | 19 | 41 | 41 | 30 | 10 | 4° | P1C-4PRF |
| 100 | 57 | 67 | M20x1,5 | 39 | 42 | 122 | 56 | 19 | 41 | 41 | 30 | 10 | 4° | P1C-4PRF |

Kolbenstangenmutter

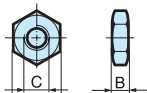

| Zyl. Ø mm | d | M | S | Bestell-Nr. |
|-----------------|----------|------|----|-------------------|
| 12 | M6 | 3,2 | 10 | 0261210800 |
| 16 | M6 | 3,2 | 10 | 0261210800 |
| 20 | M8 | 4,0 | 13 | 0261211000 |
| 25 | M10x1,25 | 5,0 | 17 | 9128985601 |
| 32 | M10x1,25 | 5,0 | 17 | 9128985601 |
| 40 | M12x1,25 | 6,0 | 19 | 0261109910 |
| 50 | M16x1,5 | 8,0 | 24 | 9128985603 |
| 63 | M16x1,5 | 8,0 | 24 | 9128985603 |
| 80 | M20x1,5 | 10,0 | 30 | 0261109911 |
| 100 | M20x1,5 | 10,0 | 30 | 0261109911 |